



AYSE EDA TARAKCI | SELECTED WORKS

The image features a series of thin, teal-colored wavy lines that originate from the left side of the frame and converge towards a single horizontal line on the right. The lines have a fluid, organic quality, resembling waves or a signal waveform. The text is positioned in the middle of the frame, centered vertically relative to the horizontal line where the lines converge.

I DESIGNED MY PROJECTS AND MY PROJECTS DESIGNED ME



AYSE EDA TARAKCI

Date of Birth: 21.06.1996
Nationality: Turkish
P: +905385705500
E: ayseedatarakci@gmail.com

EDUCATION

- 2015-2019: Bilkent University | Ankara, Turkey
Bachelor of Architecture | GPA: 3.55/4.00
- 2010-2015: Bilkent Erzurum Laboratory School (BELS)
High School | Erzurum, Turkey
IB Diploma grade: 42/45
Diploma Grade: 87/100
IGCSE Certificate

AWARDS AND HONOURS

- High Honour Certificates | Bilkent University
2015-2016: Fall Semester
2017-2018: Fall & Spring Semesters
2018-2019: Fall & Spring Semesters
- Honour Certificates | Bilkent University
2016-2017: Fall & Spring Semesters

SCHOLARSHIPS

- Bilkent University: 2015-2019 | %100 Scholarship
- KYK National Athletes' Scholarship 2015-2019
- BELS: 2010-2015 | %100 Scholarship

WORK EXPERIENCES

- 2018 August: A Architectural Design | Ankara Turkey
Office Intern
Worked on: Ankara International Exhibition and Convention Center & Atakule
Role: Digital 3D modelling, architectural drawings, presentation and topography integration
- 2017 August: Tepe-Mesa Park Mozaik | Ankara, Turkey
Site Intern
Park Mozaik Residential Complex

LANGUAGE PROFICIENCY

- Mother Tongue- Turkish
- English
- German
- Italian

EXHIBITIONS

- 2019 | CerModern
Selected Studio Project for "Prague on the Cusp of Cahnge"
- 2019 | Bilkent Department of Architecture Exhibition
Selected Studio Project for "Nautical and Aquatic Exploration Center in Alanya"
- 2018 | Bilkent Department of Architecture Exhibition
Selected Studio Project for "Co-Housing"
- 2015: International Baccalaureate Visual Arts
Exhibition: Compilation of Studio Works.

SOFTWARE LITERACY

- Rhinoceros
- Grasshopper
- 3dsMax
- AutoCad
- Revit Architecture
- V-Ray
- Keyshot
- Lumion
- Adobe Photoshop
- Adobe Illustrator
- Adobe InDesign
- Microsoft Office

PERSONAL INTERESTS

- Drawing | Charcoal, Watercolor, Acrylics, Pastels
- Archaeology | Worked as architect on the ancient site of Labraunda in summer 2019
- Fencing | National Fencer: 2010-2012
Represented Turkey in 5 International Tournaments
2-Times National Champion
3-Times Bronze Medal Winner
20+ Regional Championships
- Illustration, Photography, Traveling

REFERENCES

- Associate Profesor | Mark Paul Frederickson
Department of Architecture, Bilkent University, Ankara, Turkey
E-Mail: frederickson@bilkent.edu.tr
- Instructor | Ayşe Henry
Department of Architecture, Bilkent University, Ankara, Turkey
E-Mail: ayse.henry@bilkent.edu.tr
- Instructor | Jesus Espinoza Alvarez
Department of Architecture, Bilkent University, Ankara, Turkey
E-Mail: jesus.espinoza@bilkent.edu.tr

CONTENTS



WATERLINE



SCATTER



ALANYA MUSEUM



CO-HOUSING

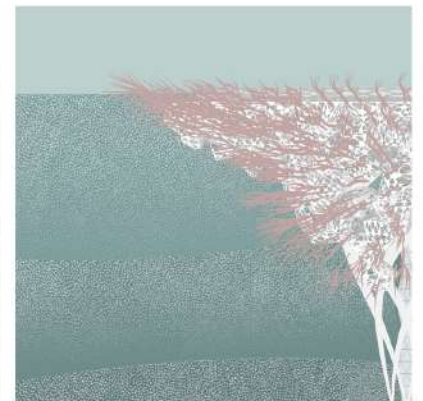

VISUALIZATIONS

WATERLINE

The site is situated in the post-industrial zone of Prague, and presently suffers the impacts of the past industrial activities. Therefore, at the southern part of the site where the industrial zone is adjacent to the historical part of the city, a water purification center is proposed. This facility exhibits different stages of the water transformation to the visitors and enables their active participation.

Architectural Design Studio VI

2018-2019 Spring

Academic Individual Work

Instructor: Mark Paul Frederickson

Bilkent University

Location: Prague | Czech Republic

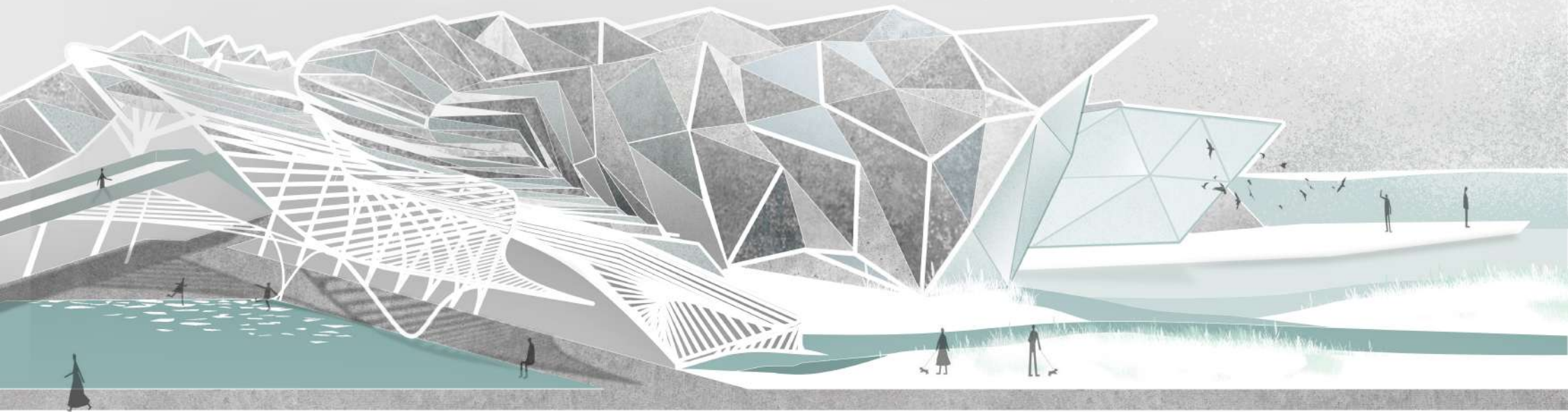

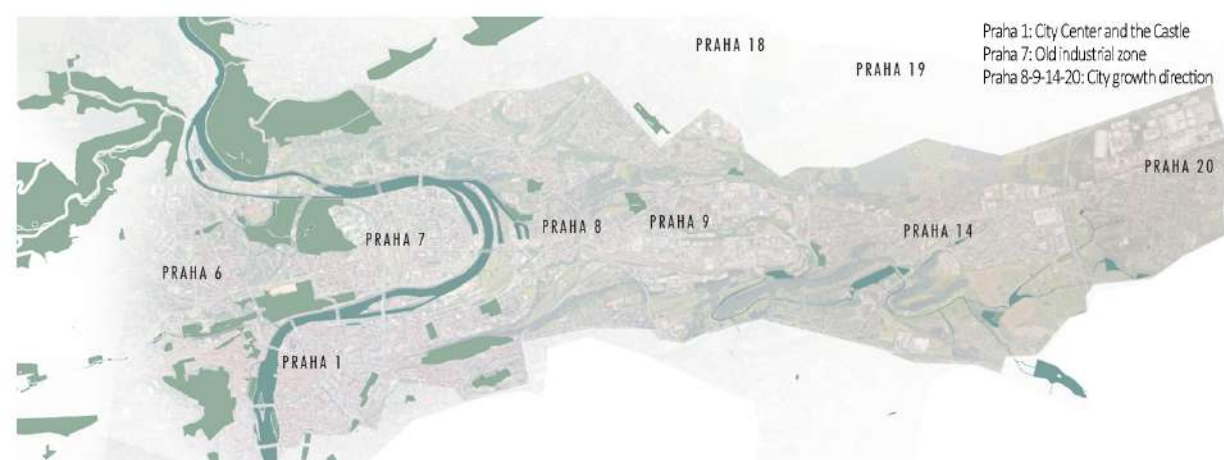

Prague consists of different districts that have sharp demographic discrepancies. The old city center and the developing parts of the city are divided by the railways making those differences even more acute. The city has been suffering urban sprawl in the eastern part and has growing problems in its infrastructure. This project aims to define a sustainable urban zone in the former industrial region, Praha 7 with the proposed water purifying center that cleanses grey water and water from urban runoff. In order to ameliorate connectivity problems among different city zones, green corridors, a city park and revitalization along the river of Vltava are proposed.

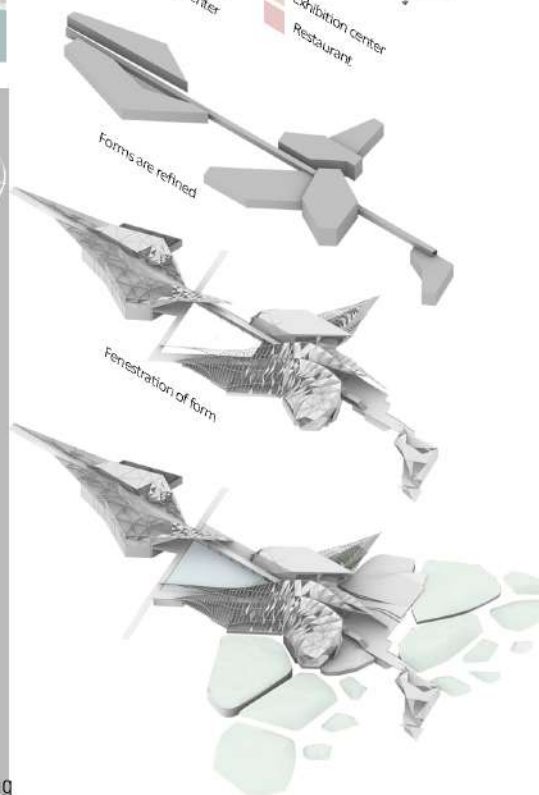
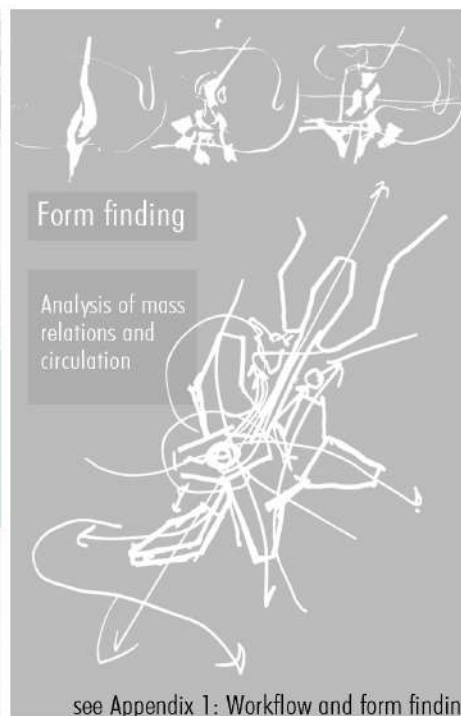
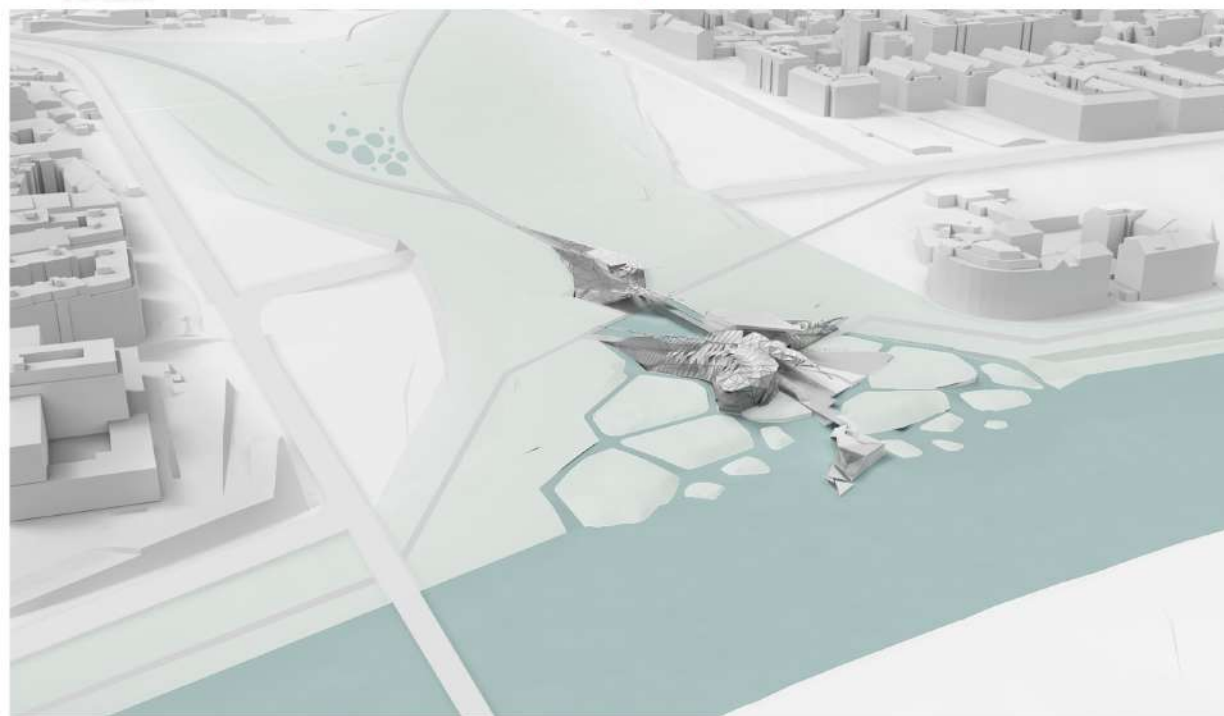
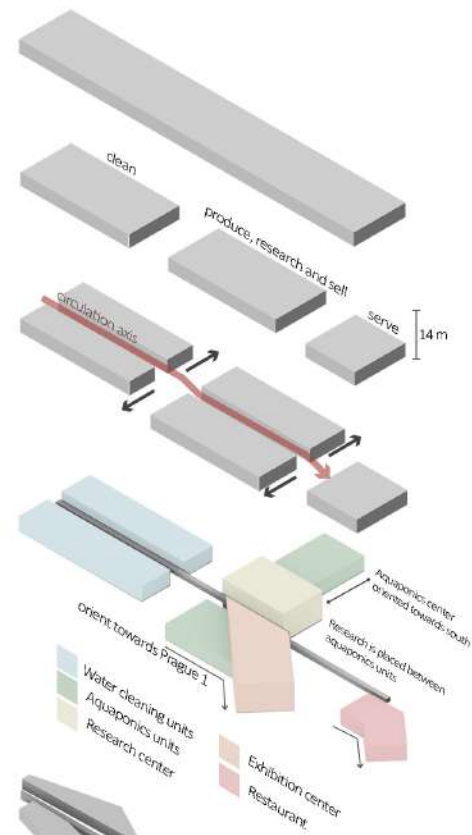
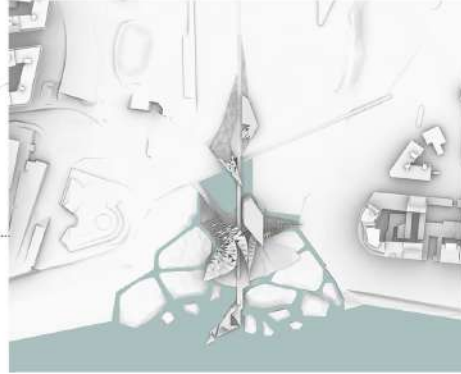
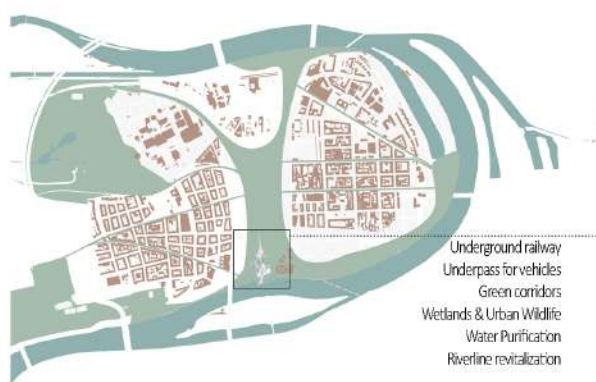
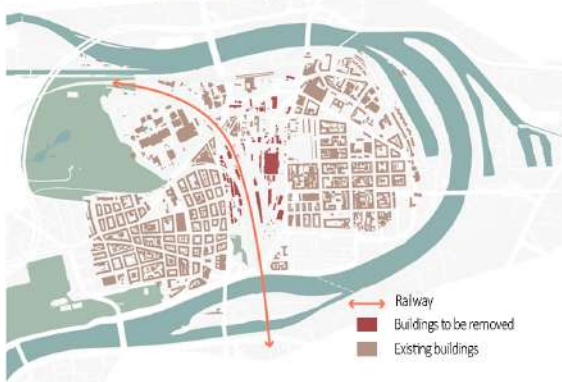

Greywater from households and urban runoff

-  Algae Plates
-  Water Harvesting from Roof
-  Transparent Solar Cells

SUSTAINABILITY SYSTEMS

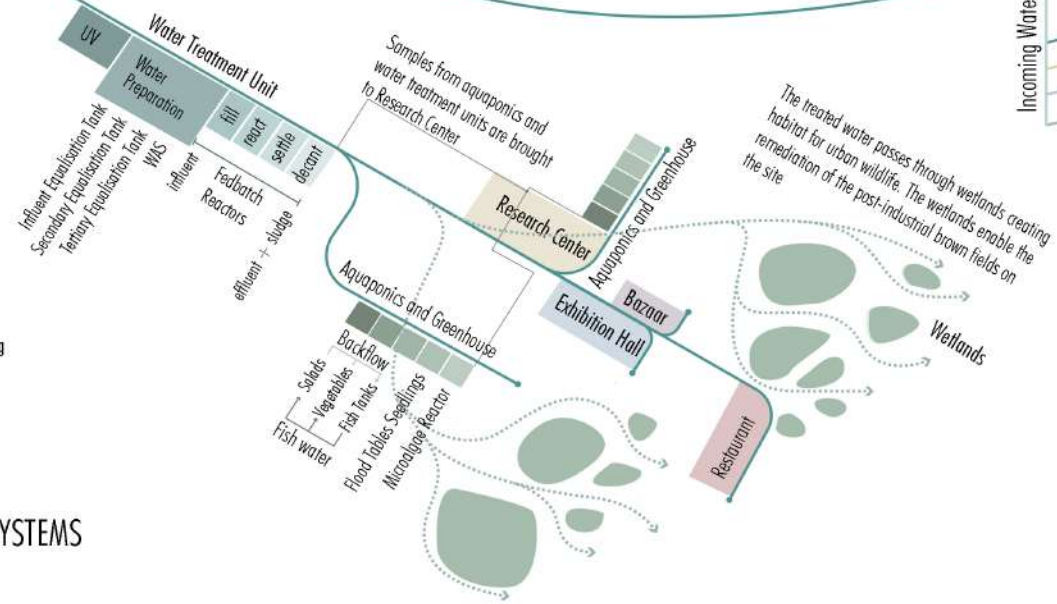

Concept: The Line of Water Transformation

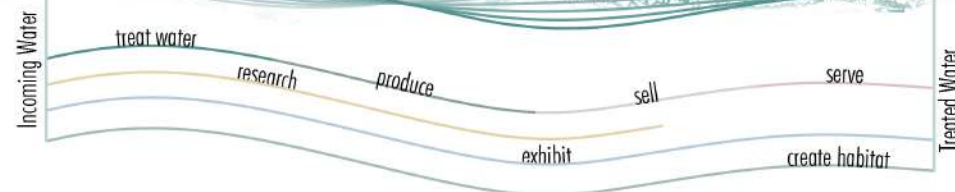

FUNCTION

-  Water Treatment Unit
-  Exhibition Hall
-  Research Center
-  Bazaar
-  Restaurant
-  Aquaponics, Greenhouses & Wetlands

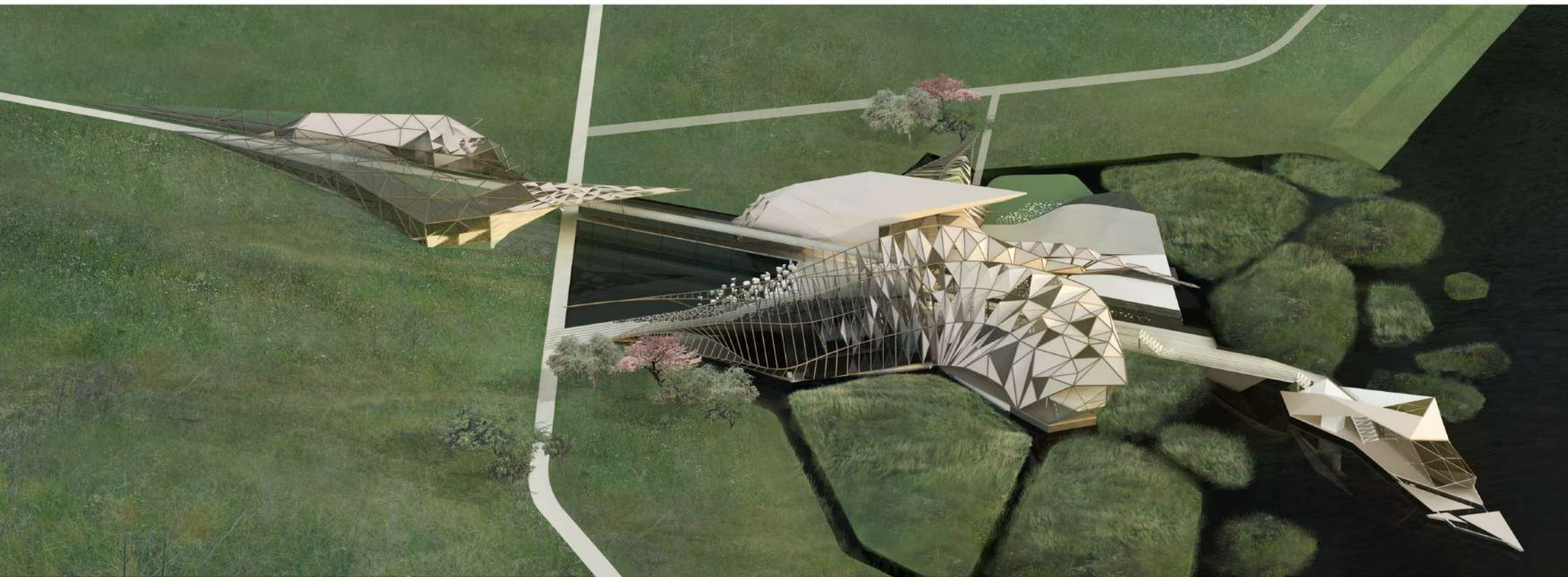



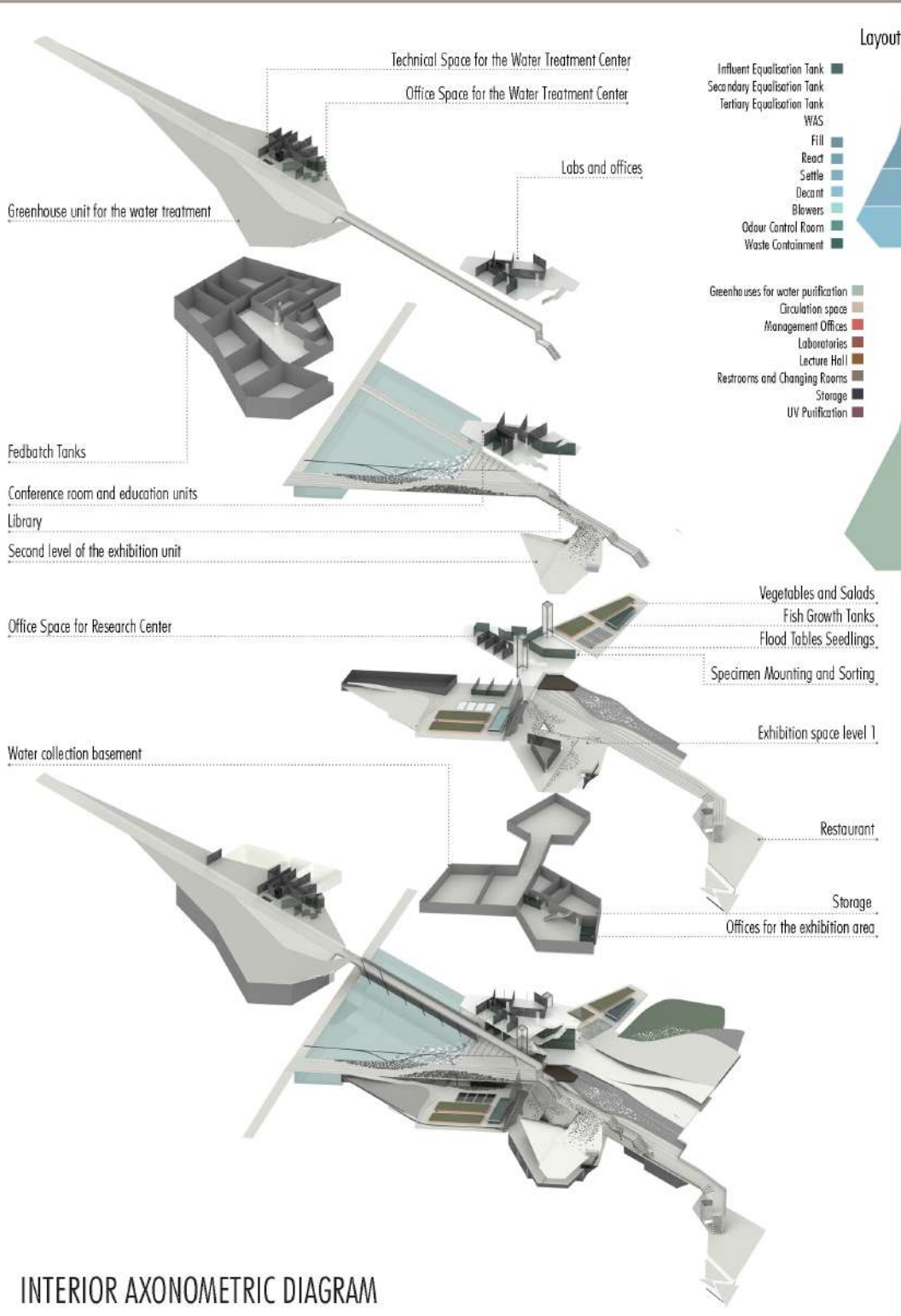

INTERIOR AXONOMETRIC DIAGRAM

Layout of the Water Purification Unit

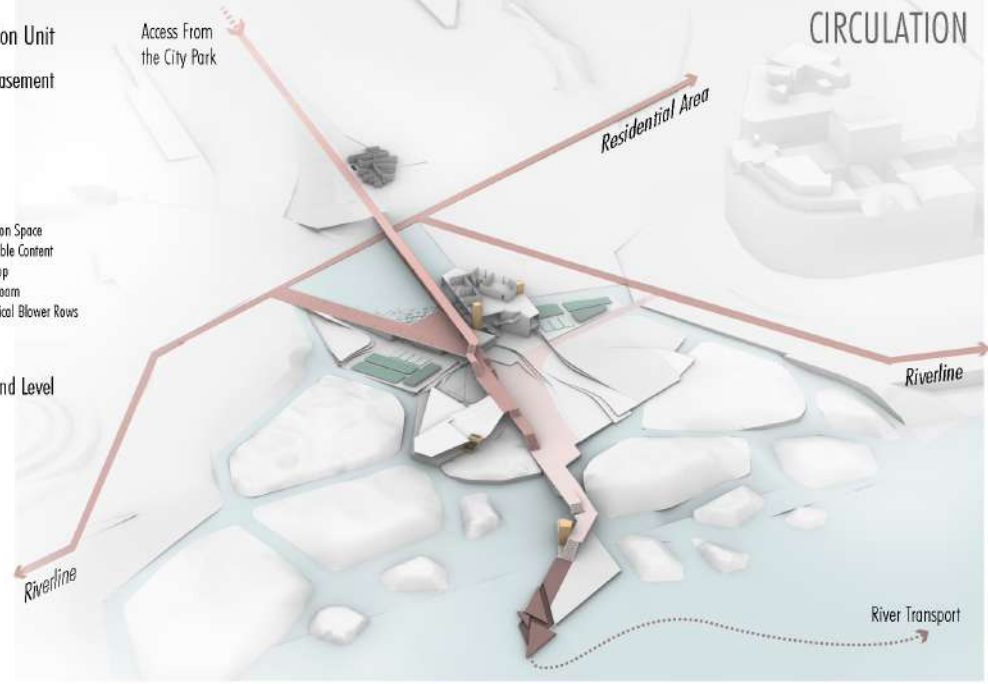
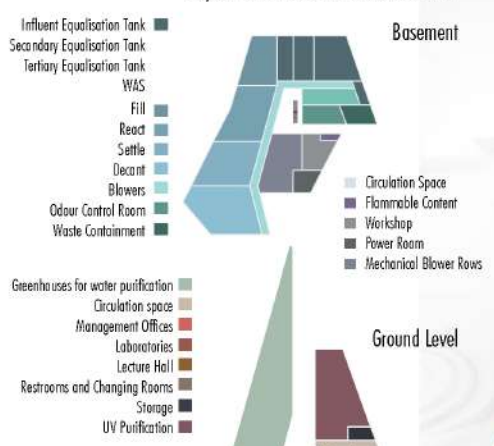

CIRCULATION



FRAME DEFORMATION

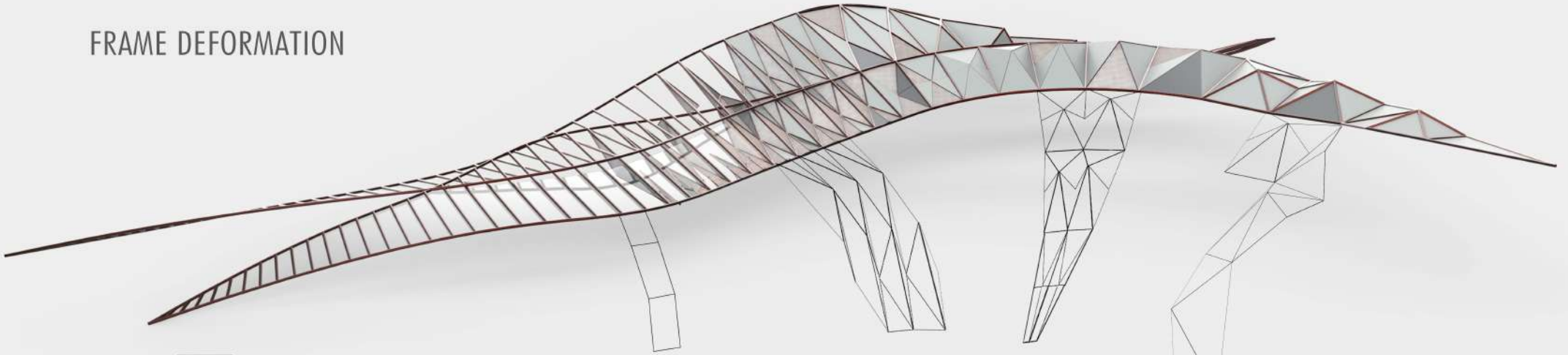

1. Rectangular Frame

2. Folded Plate Frame

3. Triangular Structure

4. Irregular Frame

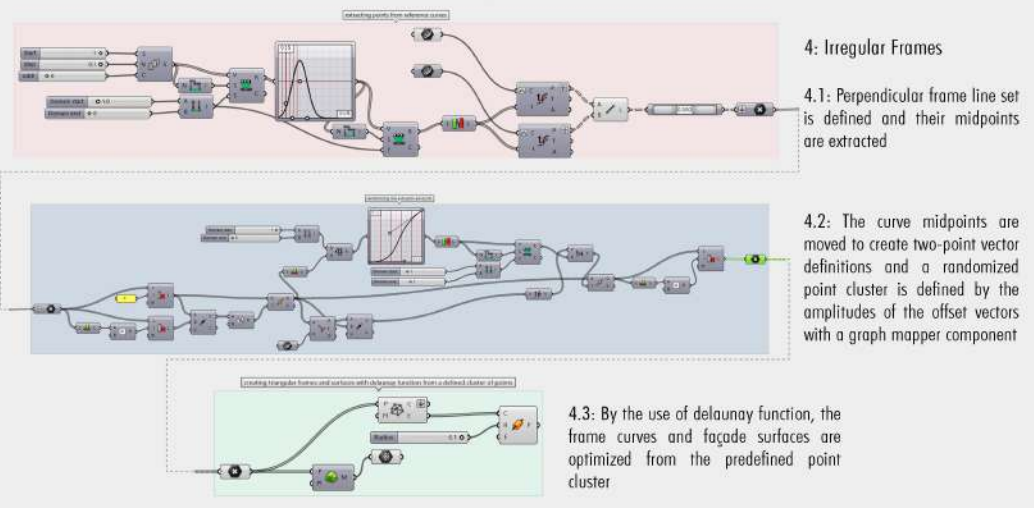
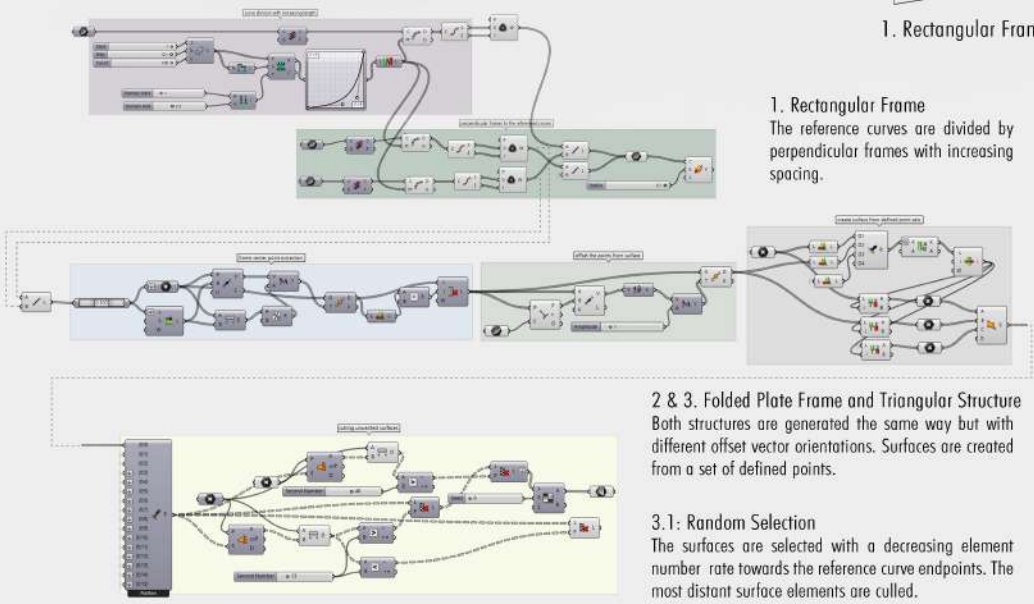

The definition of frame deformation illustrated here describes only a certain branch of the entire code.

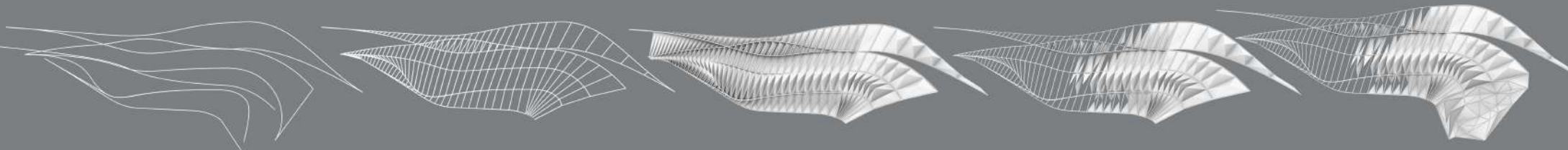

0: Reference Curves

1: Rectangular Frame with Increasing Spacing

2 & 3: Folded Plate and Triangular Structures

3.1: Culling the distant elements

4: Irregular Frame from delaunay function

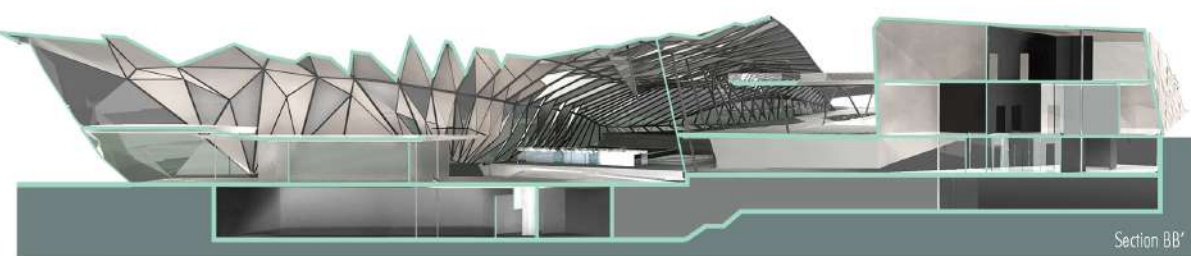
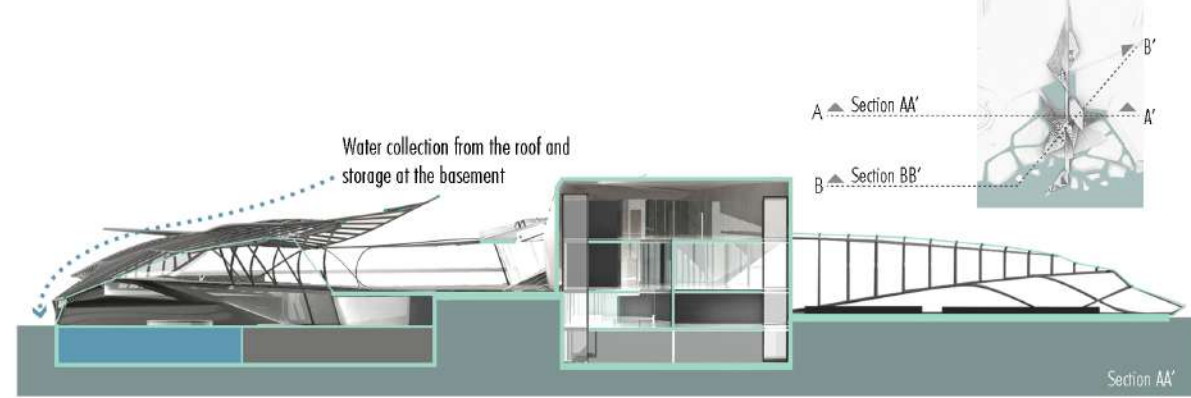
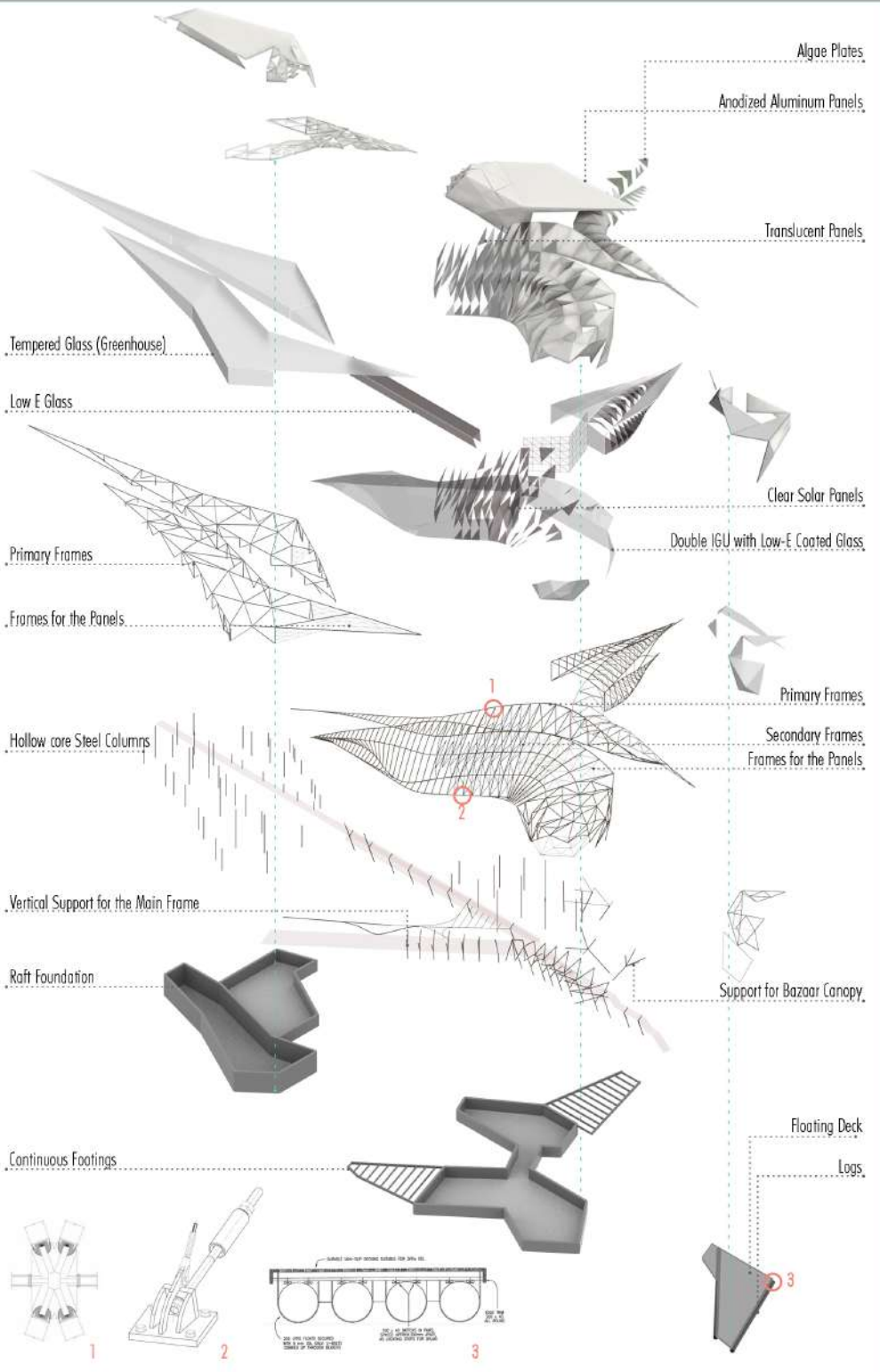

APPENDIX I: PROCESS

FORM FINDING

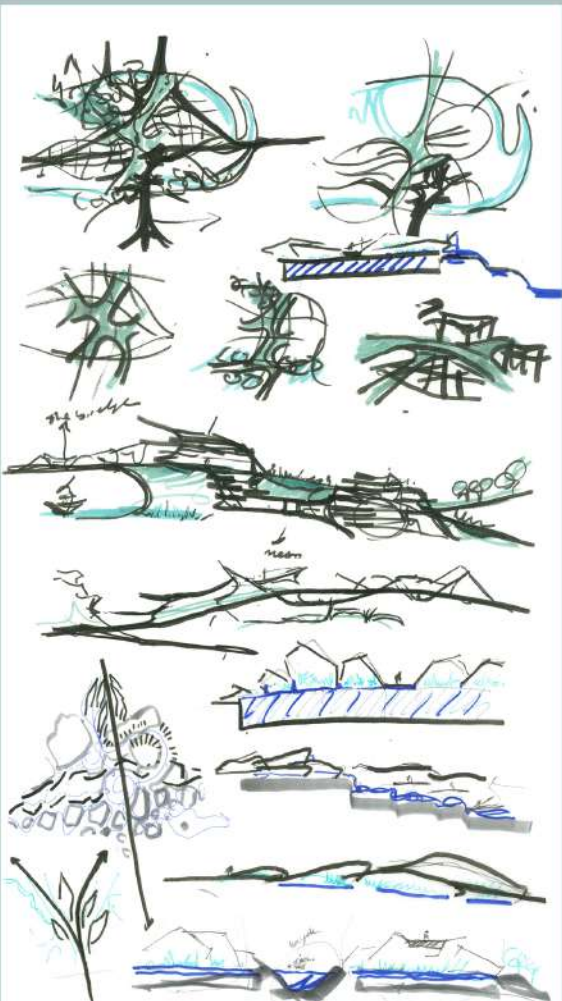
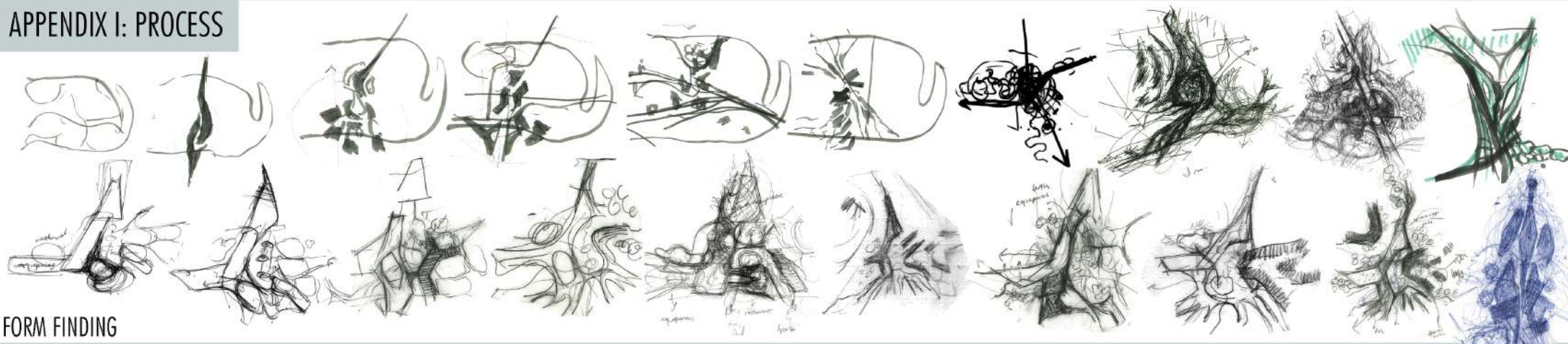

TOPOGRAPHY STUDY

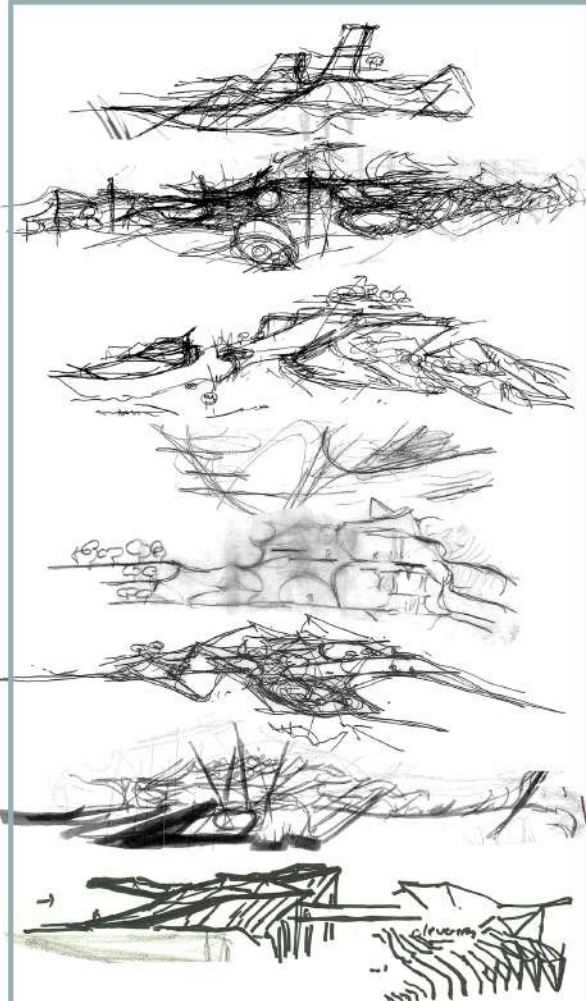

SECTION STUDY

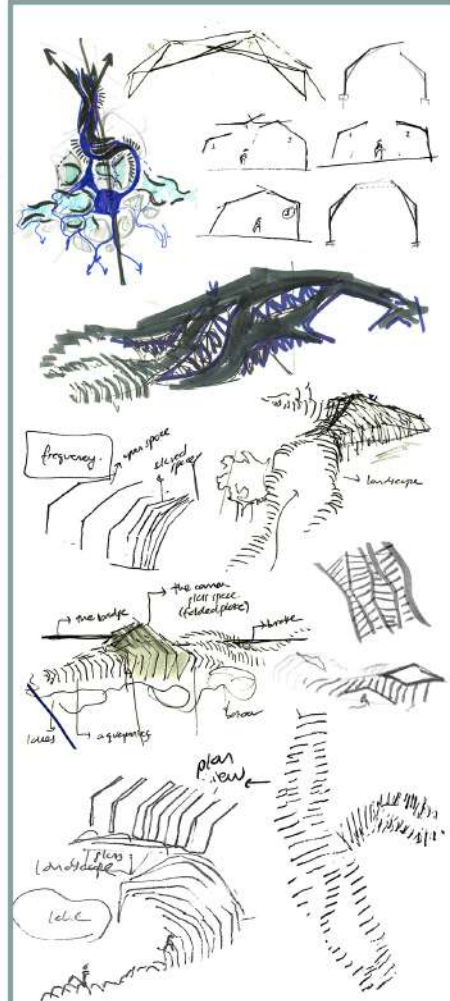

INTEGRATION OF STURCTURE

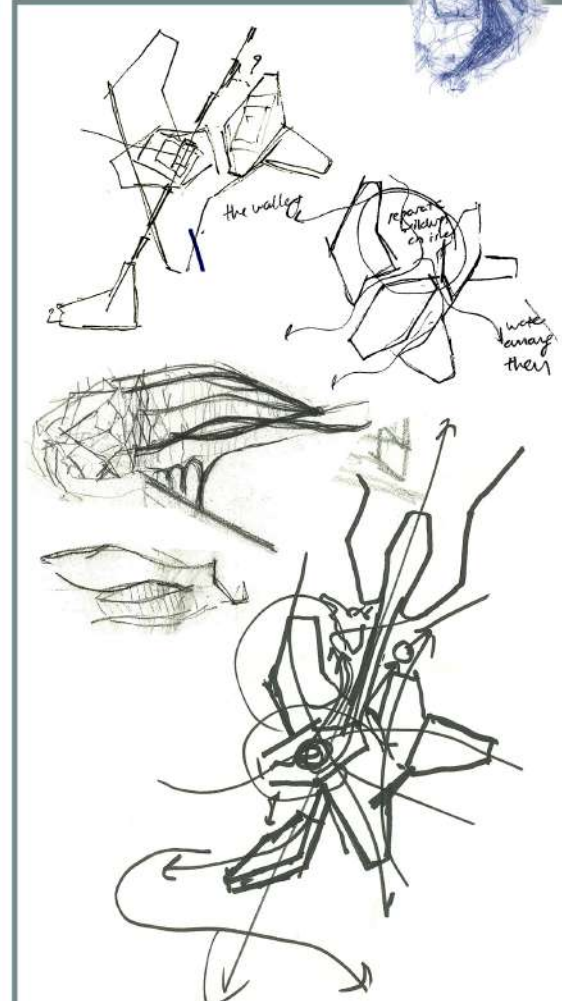

FINAL LAYOUT

Architectural Design Studio IV
2017-2018 Spring Semester
Academic Individual Work
Instructor: Glenn Terry Kukkola
Bilkent University
Location: Hatay | Turkey

SCATTER pavilion

A pavilion designed to express the traditional
southeastern Anatolian styles with a contemporary
approach



SOUTH ELEVATION



1. Creation of the core structural pattern with reference to the traditional patterns

2. Selection of the geometries from the pattern

parallelograms: shading elements ■

hexagons: paving elements and landscape ■

triangles: paving elements and landscape ■

Placement of the shading elements onto the grid

The arches are added at the ends of the pattern

Pointy arches enhance the emphasis on the use of traditional elements

The unfolded State of the structural grid

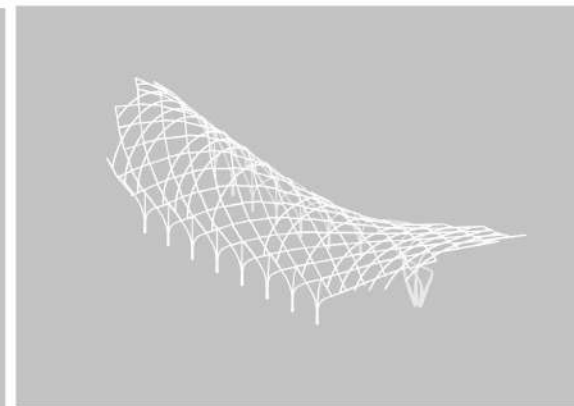
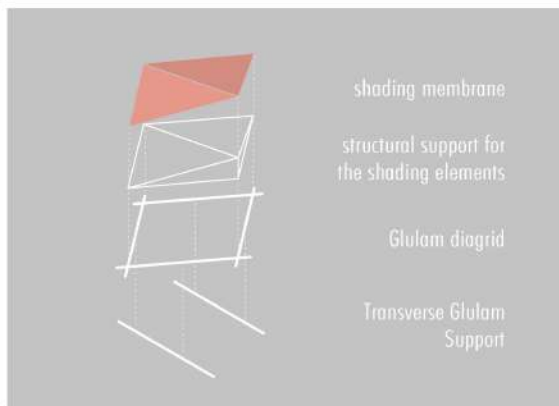
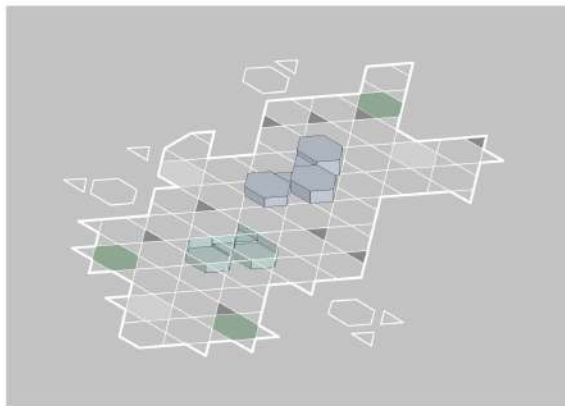
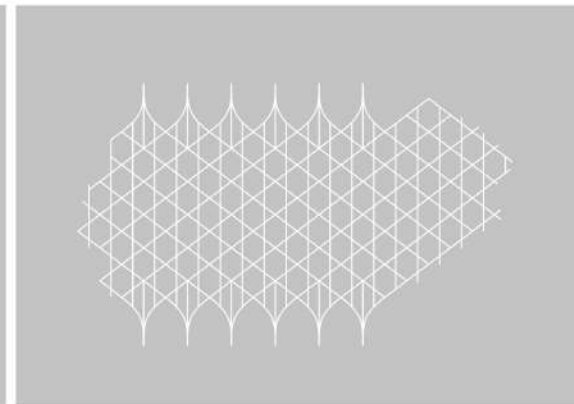
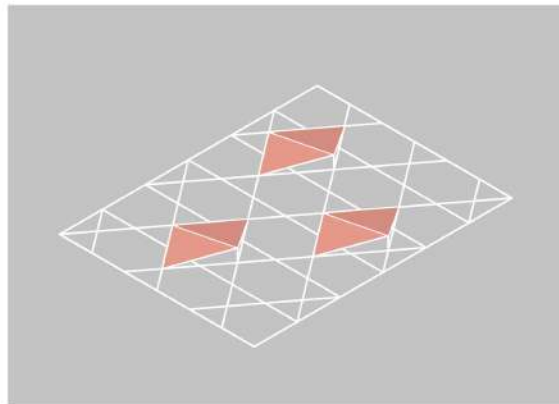
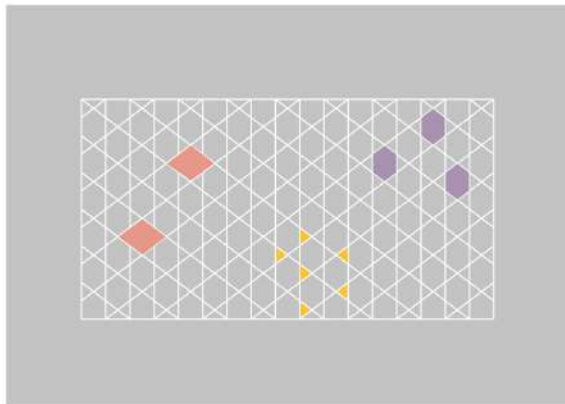

Triangular and hexagonal geometries of the structural grid are projected onto the paving.

Randomly selected triangular and hexagonal elements ■

Extrusion of the projected elements in +z to create seats ■

Extrusion of the projected elements in -z to define water elements ■

Exclusion of elements to integrate green areas into the design ■

Southeast isometric view



The pavilion is designed to allow indirect sunlight from south with gradually displaced shading elements

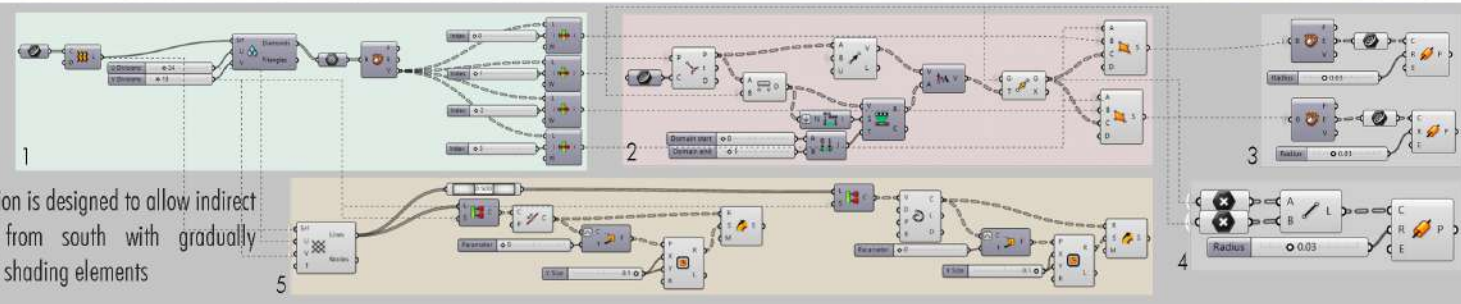

1. Extraction of Points from the diamond grid
2. Gradual displacement of the point cloud from the initial grid by a distance function and the definition of the surfaces
3. Frames of the shading elements
4. Structural diagrid frame
5. Perpendicular beam sweep

Architectural Design Studio V

2018-2019 Fall Semester

Academic Individual Work

Instructor: Jesus Espinoza Alvarez

Bilkent University

Location: Alanya | Turkey

ALANYA ARCHAEOLOGY MUSEUM



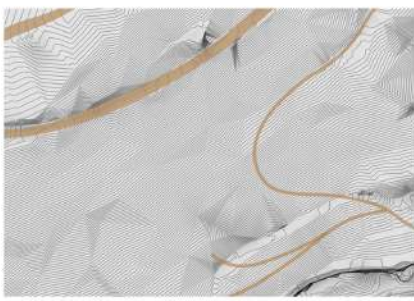

Topography curves and existing roads

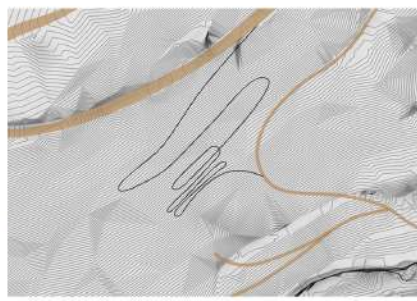

Proposed pedestrian path to improve accessibility

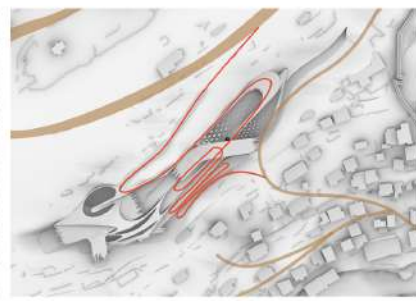

Functions are added

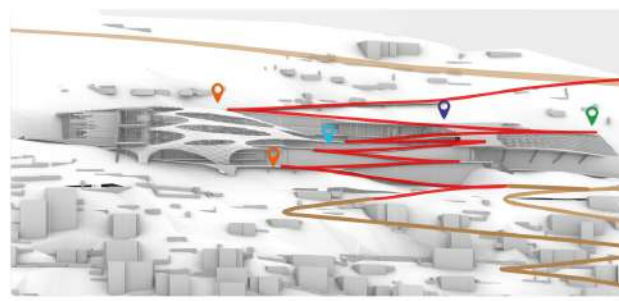

Final Design in elevation

Experiencing the site through the introduction of a new circulatory path:

- Greenhouses
- Restaurant
- Bio-Market
- Underwater Archaeology Museum

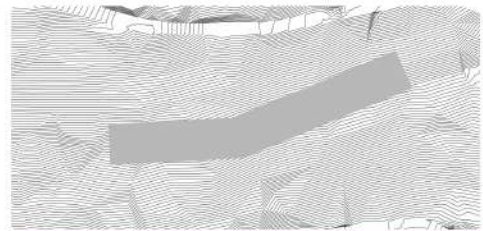

S ← → N

The mass is placed to follow the topography lines. Hence the mass is north-south oriented

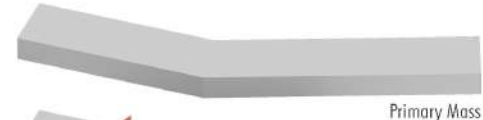

Primary Mass



shipyard

city harbour

The mass is divided by functions: Archaeology Museum and Greenhouses. The orientations of the views to be framed are determined.



Slabs are defined

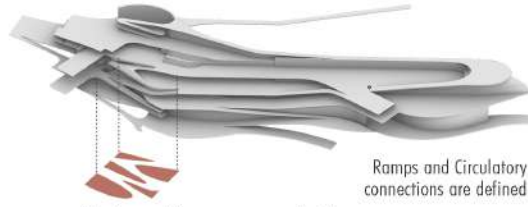

Ramps and Circulatory connections are defined

The forms of the ramps are projected outwards to define the façade form

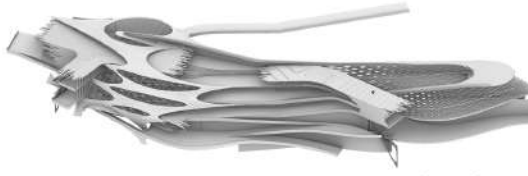

Articulation of Forms



AESTHETICAL



ECONOMICAL



ENVIRONMENTAL



SOCIO-CULTURAL

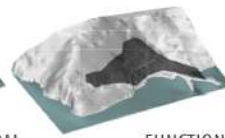

FUNCTIONAL

Zoning of the Site According to the Ordering Systems

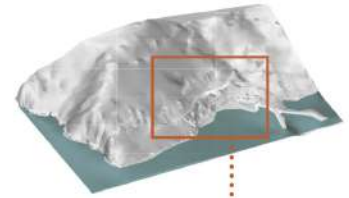

Situated in the historical district of Alanya, this design aims to provide accessibility among the urban areas of different levels. Due to the steep topography, the existing urban texture in the region is rather detached, and the design of the museum aims to organically incorporate this underused zone through the generation of an alternative route for pedestrians and cyclists. The function of the design being "Archaeology Museum" revives the values, and through the display of the historical artifacts excavated in the region, encourages the participation by locals and visitors.



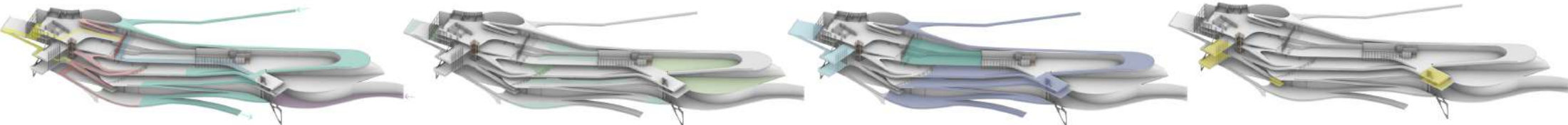

	CIRCULATION		GREEN AREAS		RESTRICTED OPEN AREAS		FRAMED VIEWS
Circulation Restricted to Museum and Restaurant Visitors	General Circulation	Open Green Areas	Open Green Areas	Accessible to Everyone	Accessible to Museum and Restaurant Visitors	Observation Decks	
Car Access for Unloading	Museum Circulation	Greenhouses	Greenhouses	Accessible to Museum and Restaurant Visitors	Only Accessible to Museum Visitors		
	Museum Secondary Circulation	Indoor Green Areas	Indoor Green Areas				



INTERIOR AXONOMETRIC

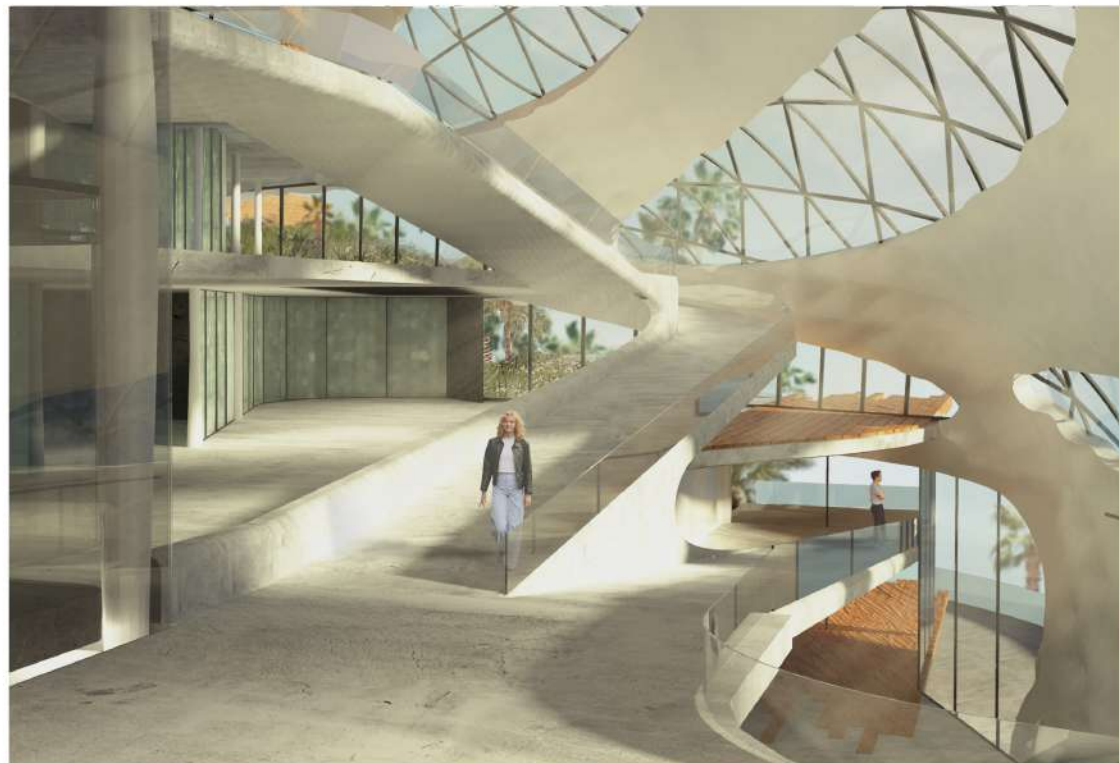
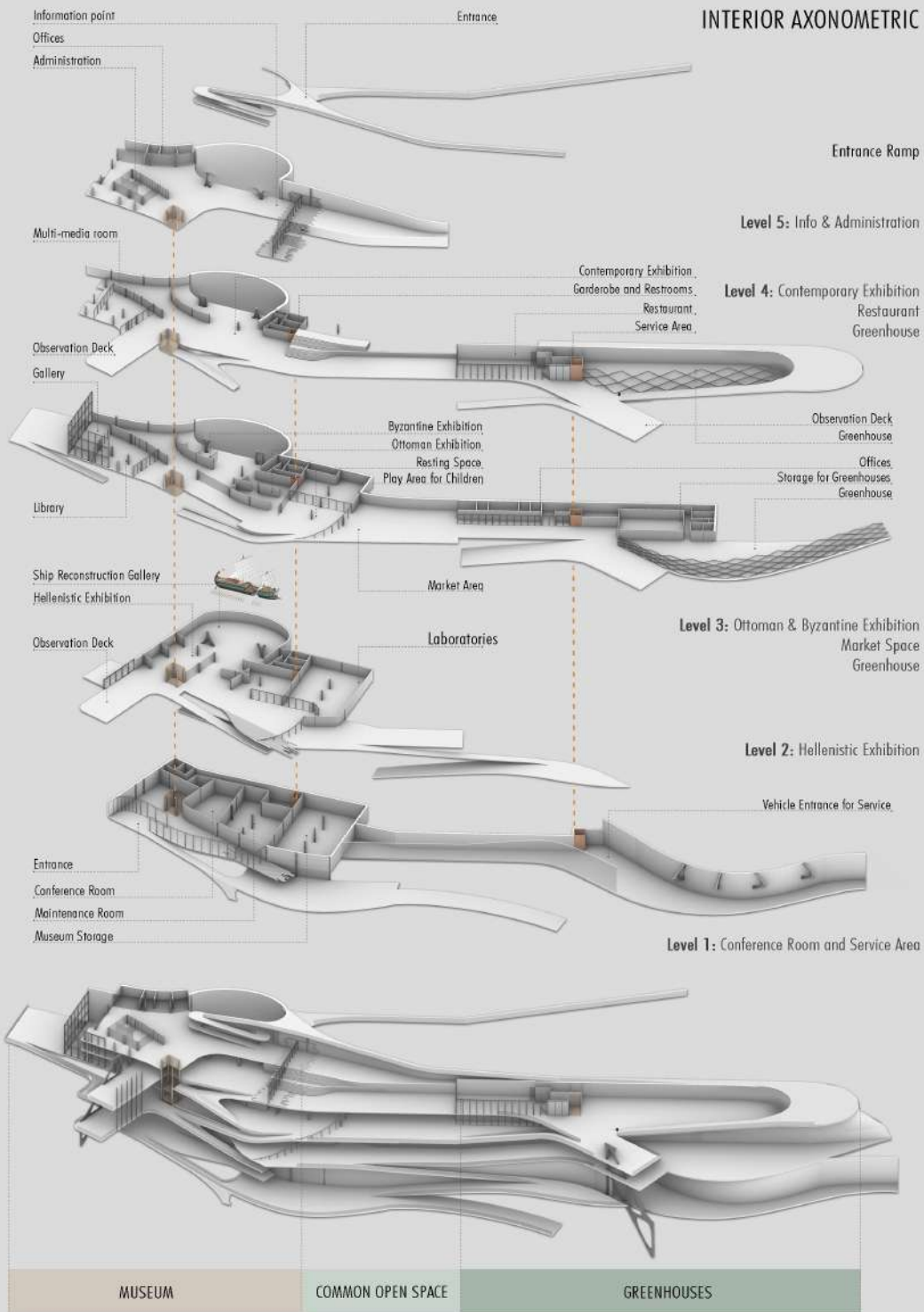

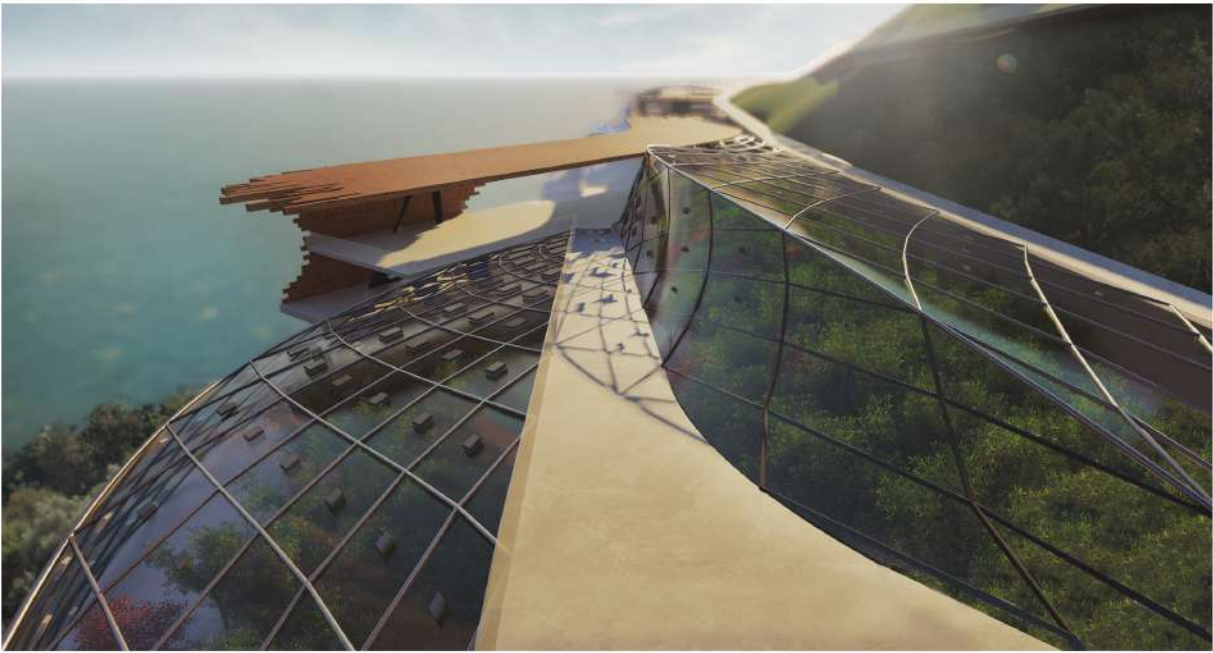
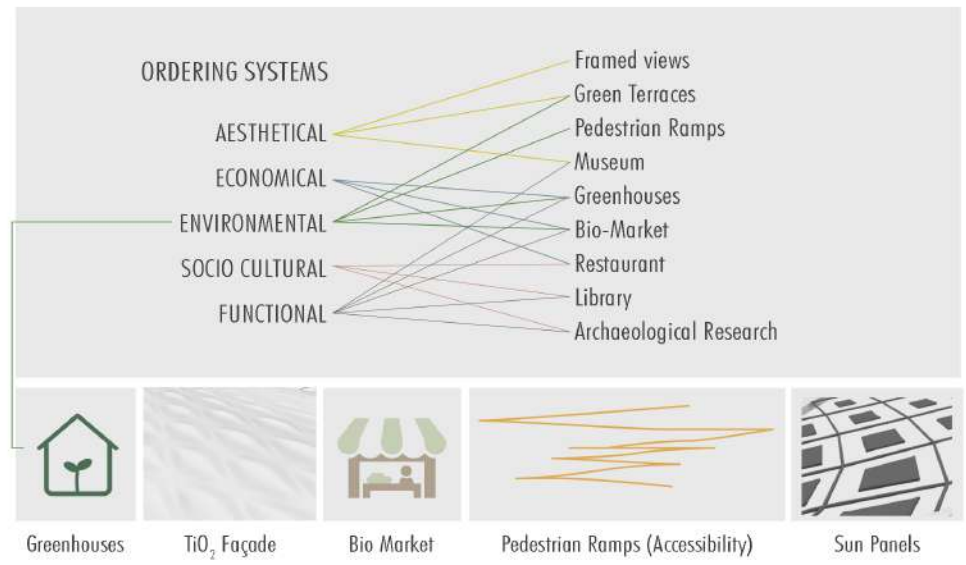
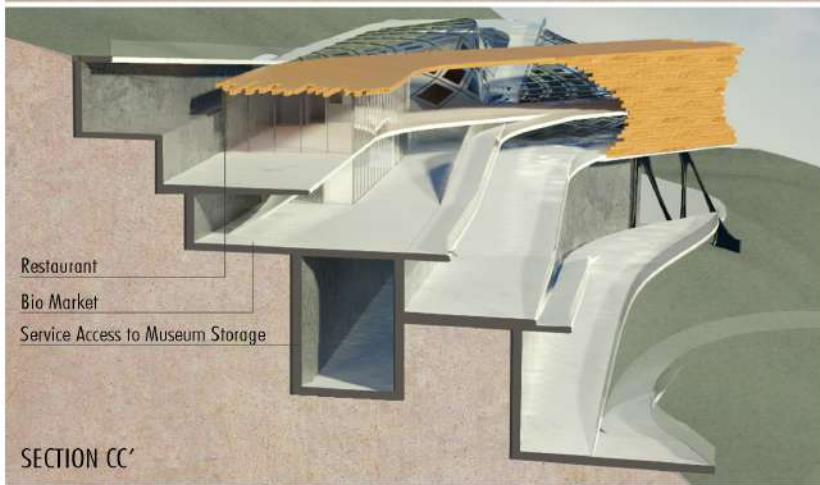
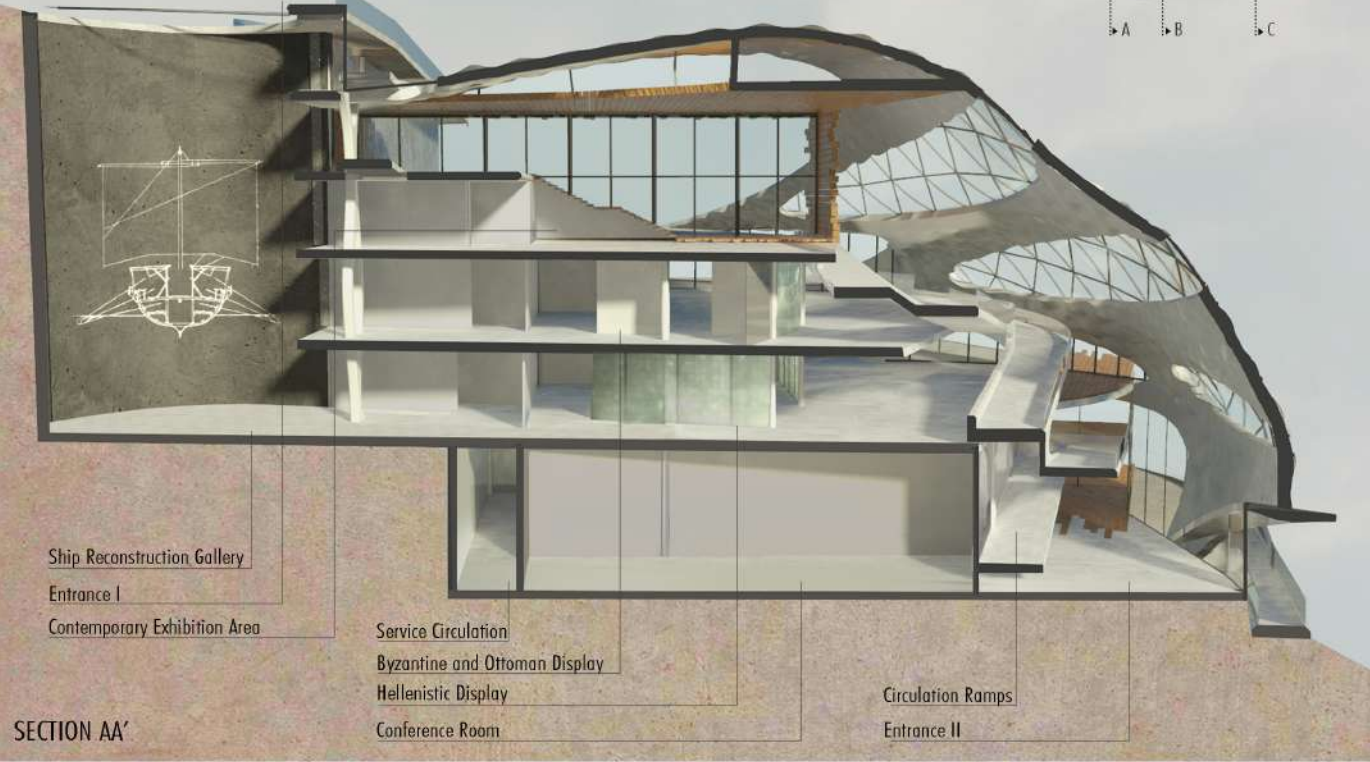
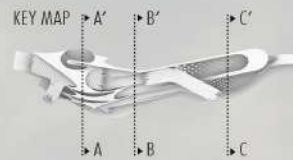

INCREASING THE SURFACE AREA OF THE TITANIUM DIOXIDE FAÇADE SKIN

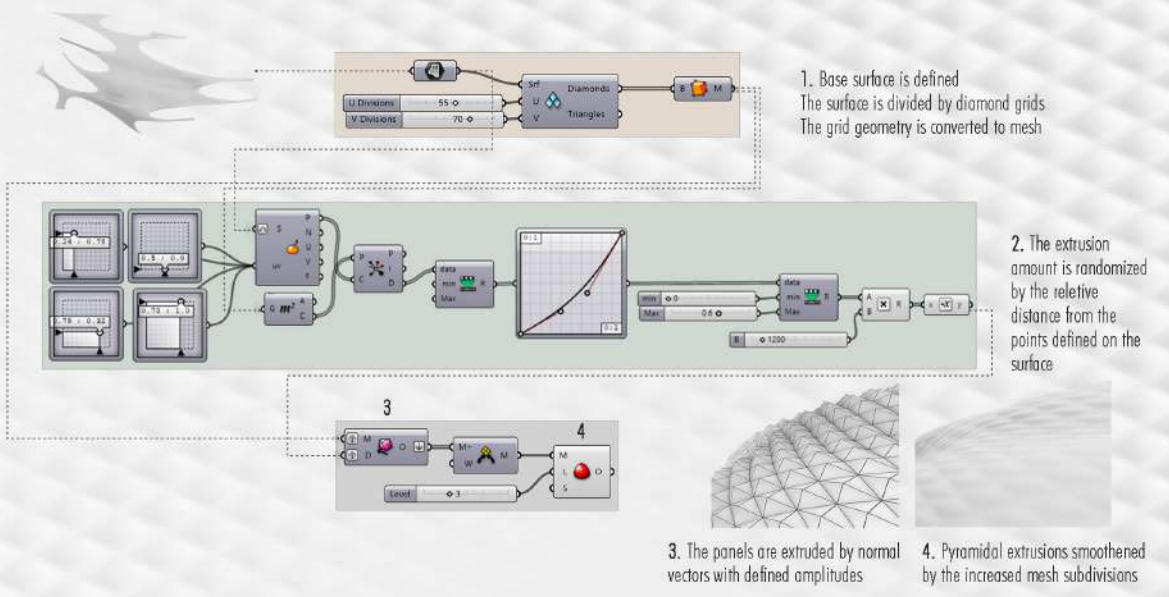

STRUCTURAL AXONOMETRIC DIAGRAM

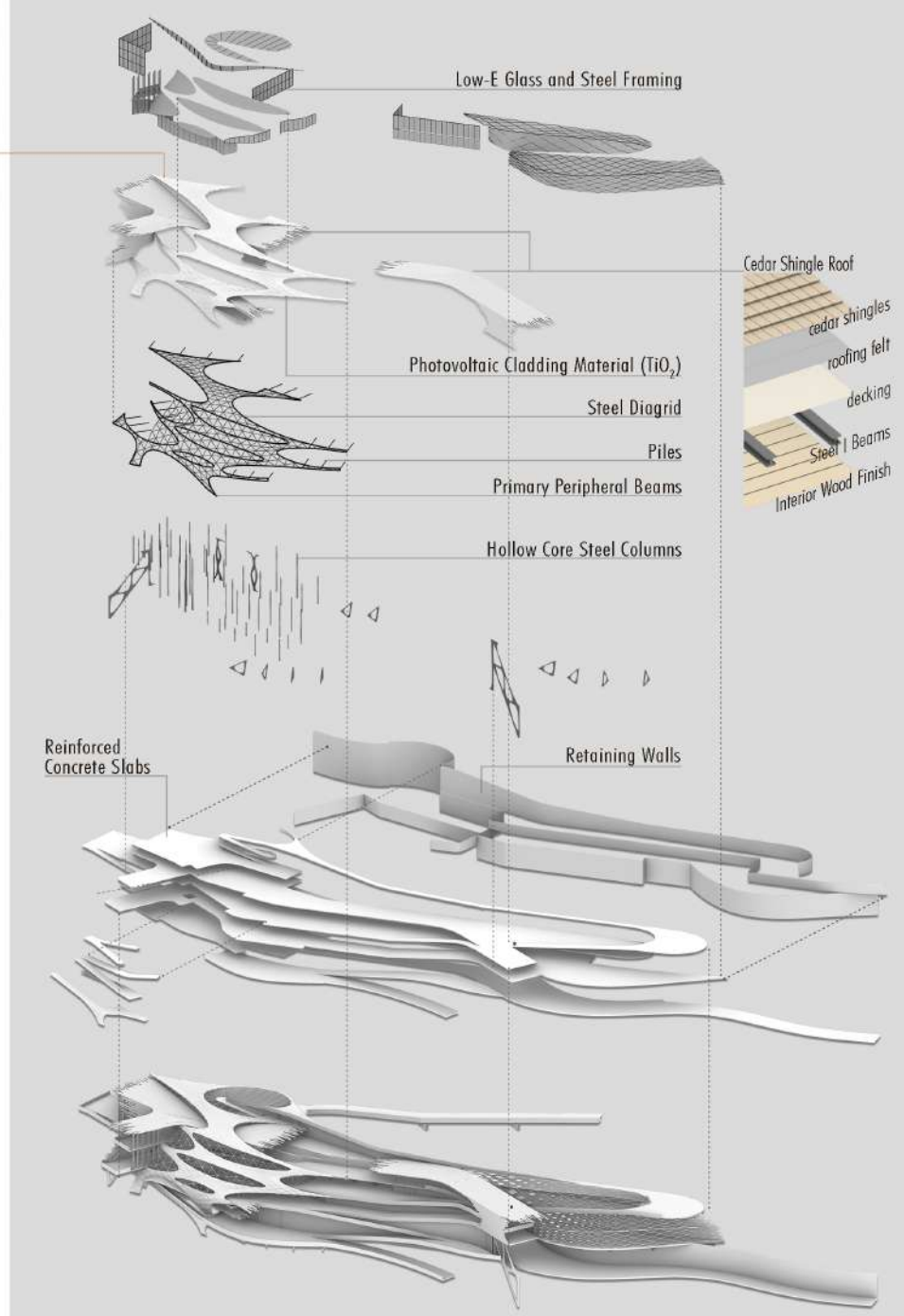

CO HOUSING

A proposal for sustainable housing, continuous green spaces and increased pedestrian connectivity at the heart of Ankara

Architectural Design Studio III

2017-2018 Fall Semester

Academic Individual Work

Instructor: Mark Paul Frederickson

Bilkent University

Location: Ankara | Turkey

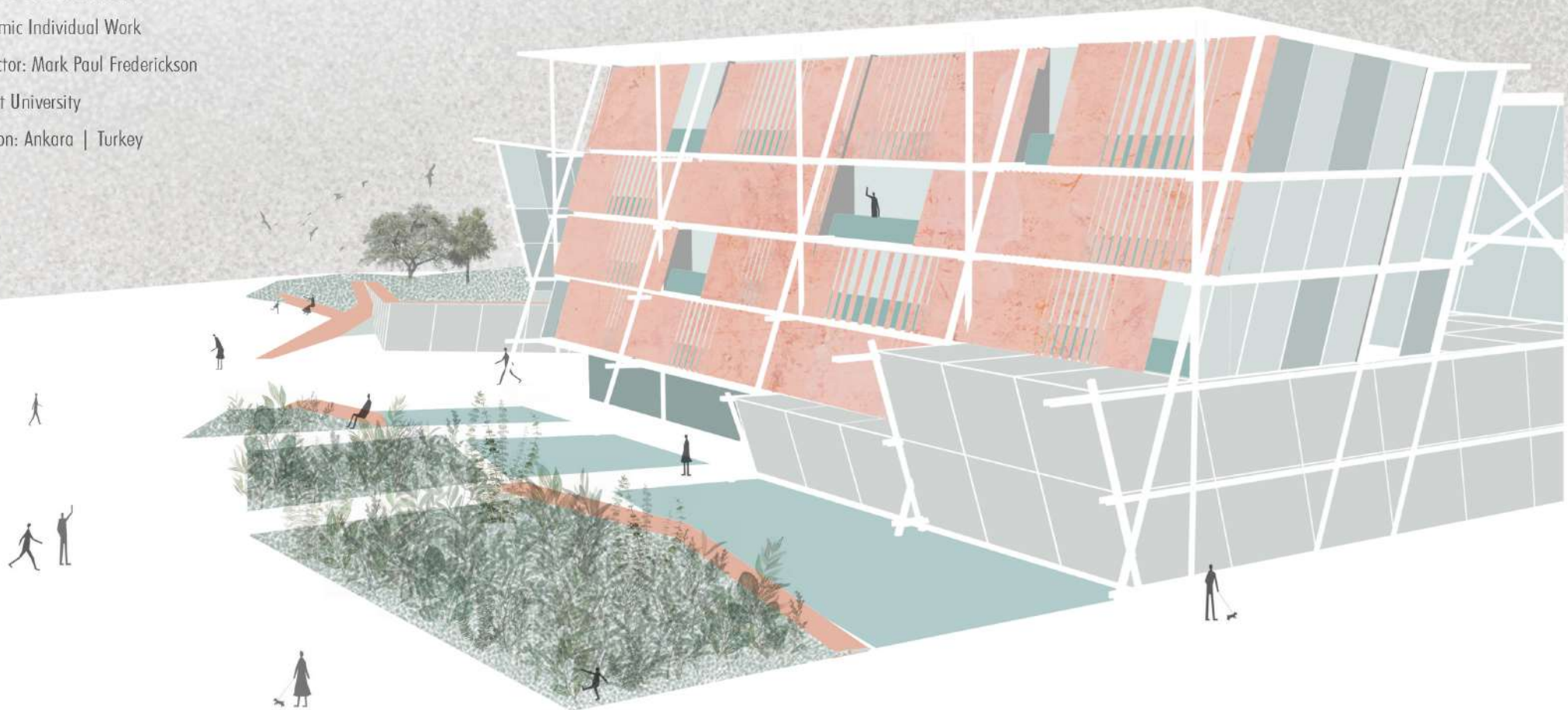

CONTEXT



1.1 Aerial View of the Site in a Greater Context



2.1 The Site is Located at a Primary Intersection



3.1 Green Patches Around the Site



1.2 Aerial View of the Site



2.2 The Site & Primary and Secondary Roads



3.2 Green Patches Around the Site



2.3 Proposed Underpass



3.3 Proposed Green Corridors and Connection Amongst Green Patches

Atakule: A Symbolic Building of Ankara



Botanical Garden

Portakal Cicegi Garden



1. Buildings to be removed



2. Existing Vehicle Circulation



3. Designated Underpass for Vehicles and the New Circulation Route Defined for Pedestrians and Cyclists

Circulation Route for Pedestrians and Cyclists
Circulation for Vehicles

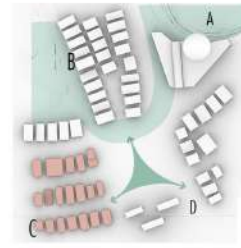

4. Continuity of Circulation is Provided and Secondary Circulation Routes are Enhanced

A. Botanical Park
B. Portakal Cicegi Park
C. Local Shops and Cafes
D. Primary Circulation Path
Connected Green Areas
Local Commercial Units

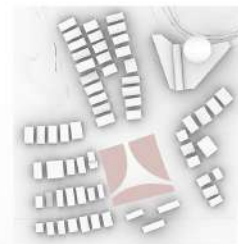

5. Negative Space is Extracted

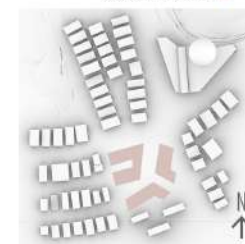

6. Final Massing is Defined

FORM GENERATION



7. Mass is Extruded



8. Greenhouse and Internal Circulatory Connection are Integrated

Circulatory Connection
Greenhouse



9. North Facades are Leaned Backwards and South Facades are Leaned Forwards for Controlling Sunlight



10. The Form is Articulated

Local Shops

The site is located at a critical junction where two main axes intersect. (See diagram set 2.2) Right across the site is located an important city symbol, Atakule. Around the site, there are detached patches of green areas which have no continuity amongst themselves (See diagram 3.2).

The design moves the traffic circulation underground via the proposition of an underpass (See diagram 2.3) Then the green patches are connected through the pedestrianized areas and the green corridors. The form is generated to improve the circulation for pedestrians and cyclists (See form generation diagrams)

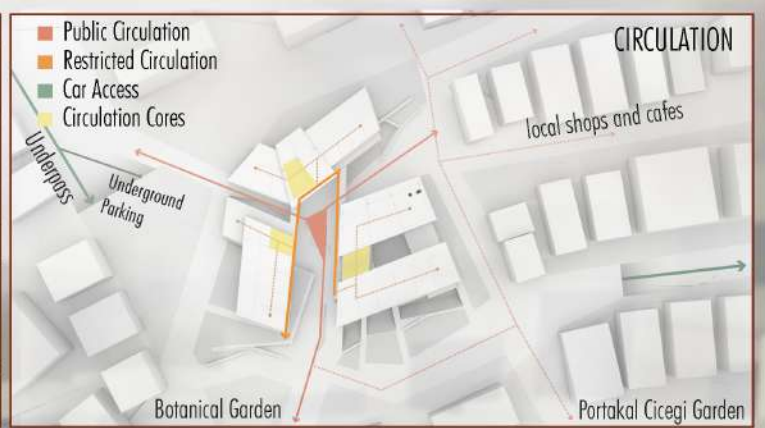
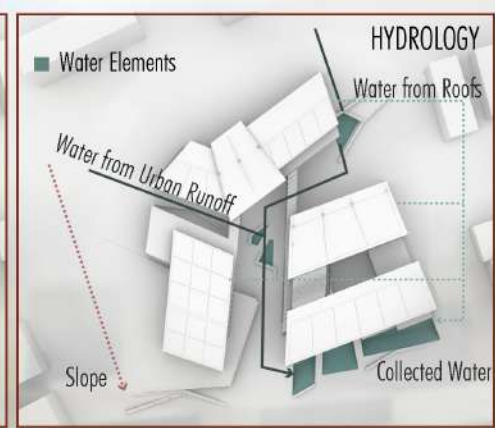
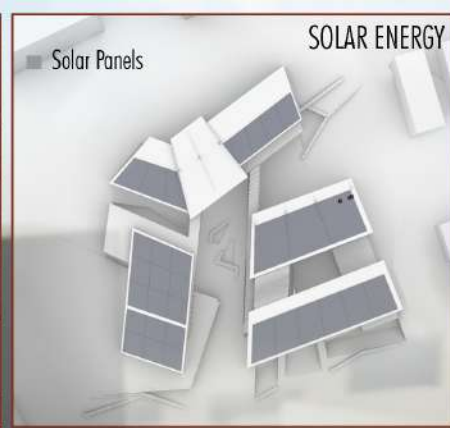

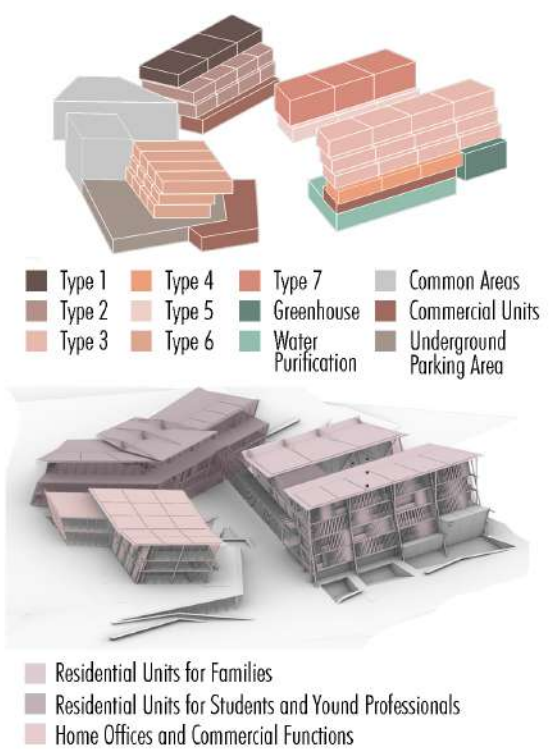

CIRCULATORY BRIDGE

MAIN RESIDENTIAL BLOCK

GREENHOUSE

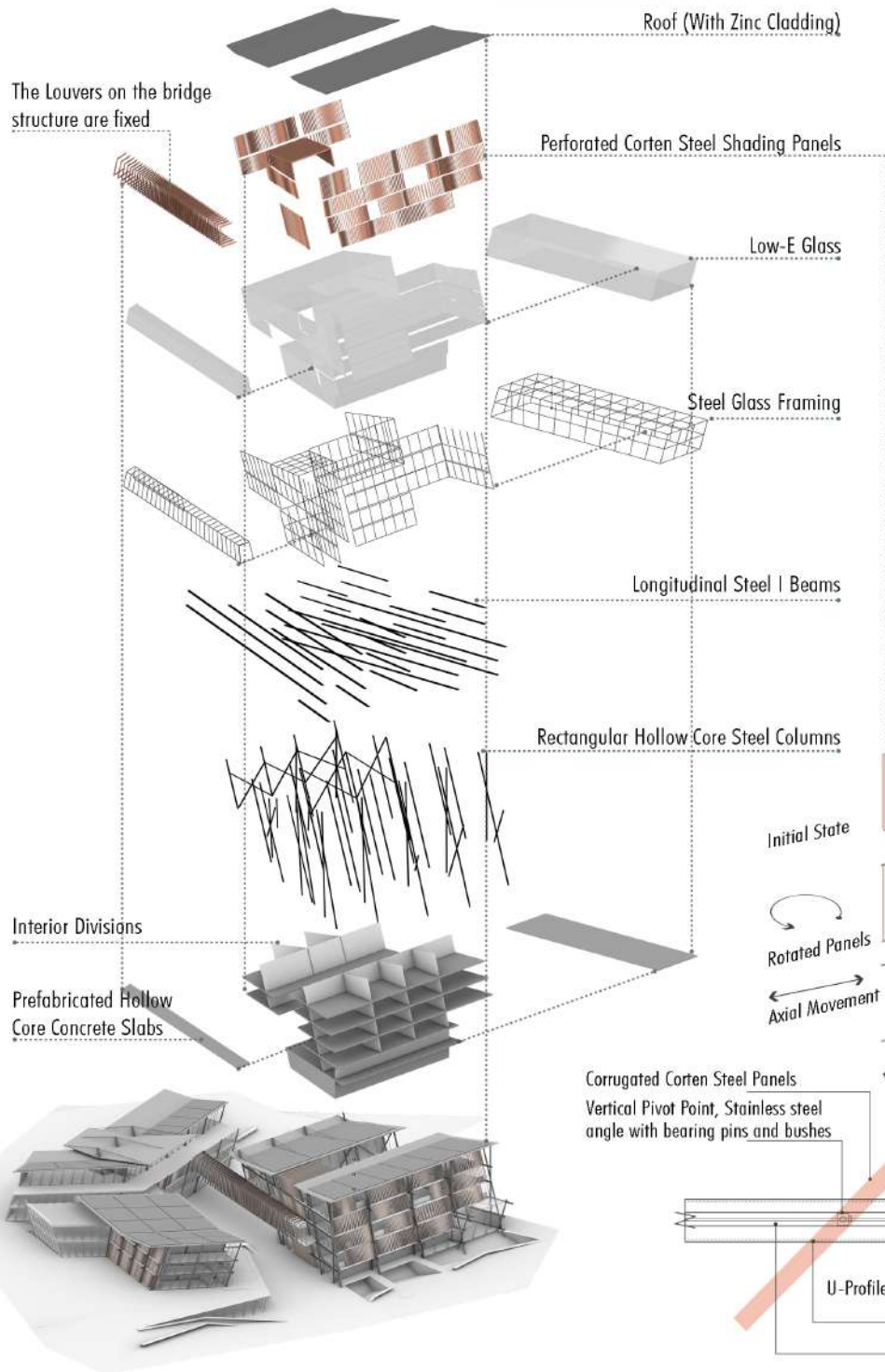

VISUALIZATIONS

